

Voyager 100 Series

User Guide

Contents

Pair	3
Get Paired	3
Pair second device	3
NFC pairing	3
Fit	4
Charge	5
The basics	6
Headset overview	6
Power on/off	6
Make/Take/End Calls	6
Mute	7
Adjust the volume	7
Play or pause audio	7
Track forward	7
Track backward	7
Support	8

Pair

Get Paired

The first time you power on your headphones, the pairing process begins.

- 1 Slide the power switch on. You hear "pairing" and the LEDs flash red and blue.

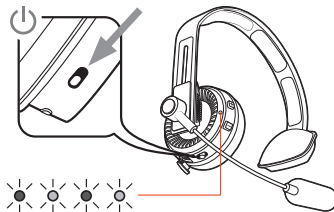

- 2 Activate **Bluetooth®** on your phone and set it to search for new devices.
 - **iPhone Settings > Bluetooth > On***
 - **Android Settings > Bluetooth: On > Scan for devices***

NOTE *Menus may vary by device.

- 3 Select "PLT V100 Series."

If necessary, enter four zeros (0000) for the passcode or accept the connection.

Once successfully paired, you hear "pairing successful" and the LEDs stop flashing.

Pair second device

Slide and hold the power button towards the Bluetooth icon until the LEDs flash red and blue.

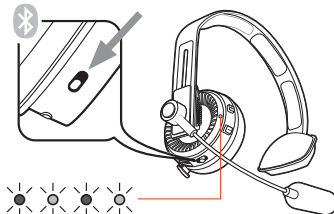

NFC pairing

- 1 Ensure NFC is on and your phone's display is unlocked.
- 2 Tap and hold the headphones to the phone's NFC tag location until NFC pairing completes. If necessary, accept the connection.

TIP Keep an eye on your Smartphone's screen for prompts to start and accept the pairing process.

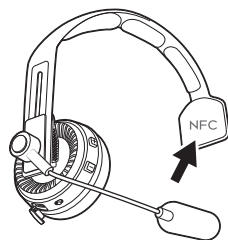

Fit

For the best fit and sound quality, adjust the headband.

- 1 Lengthen or shorten the headband until the ear cushions fit comfortably over your ear.



- 2 Position the stabilizer T-pad above your ear.

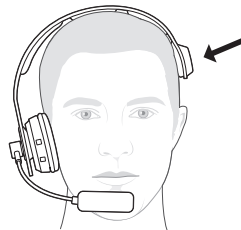

- 3 Stretch and bend your headset for a perfect fit.

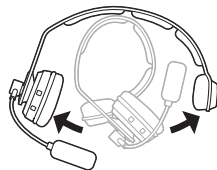

- 4 To wear the microphone on the other side, rotate the boom up and over.

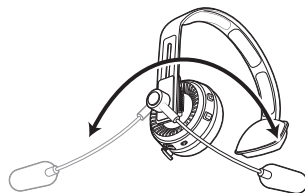

- 5 Adjust the boom so it points to the corner of your mouth.

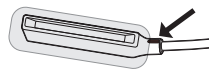

Charge

It takes up to 2 hours to fully charge your headphones. The LED turns off once charging is complete.

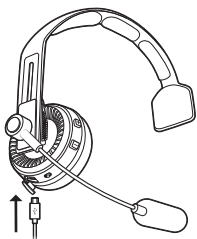



TIP To check the battery status, press the power button towards the Bluetooth button while wearing your headphones and not on a call.

The basics

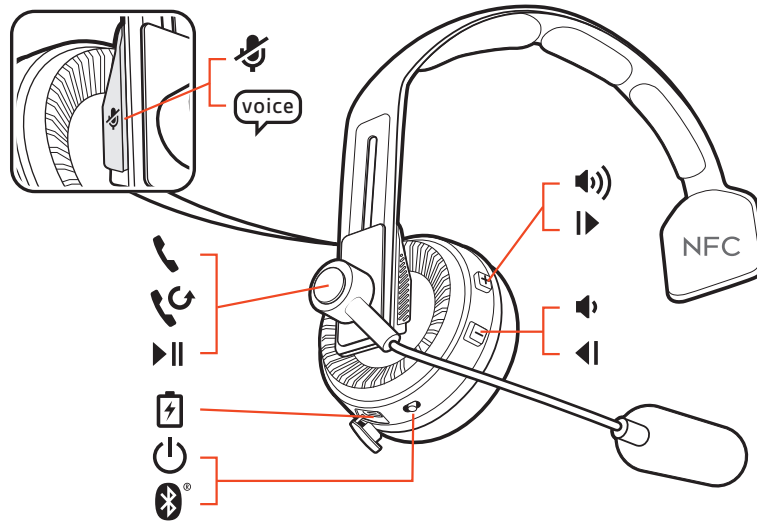
Headset overview





 Mute/unmute (during a call)

 Activate voice assistants such as Siri® and Google Now™ (while not on a call)

 Call button

 Redial

 Play/pause*

 Charge port

 Power button

 Bluetooth pair

 Volume up button

 Track forward*

 Volume down button

 Track backward*

NOTE *Functionality varies by application.

Power on/off

Slide the switch to power on or off.

Make/Take/End Calls

Answer or end a call

Tap the Call button.

Answer a second call

First, tap the Call button to end current call, then tap the Call button again to answer new call.

Redial last outgoing call

Double-tap the Call button.

Activate voice assistant

If your smartphone has a voice-enabled assistant, press and hold the Mute button for 2 seconds and wait for the phone prompt.

Mute

While on an active call, tap the red Mute button.

Adjust the volume

Tap the Volume up (+) or down (-) button.

Play or pause audio

Tap the Call button.

Track forward

Press and hold the Volume up (+) button for 2 seconds to skip to the next track.

Track backward

Press and hold the Volume down (-) button for 2 seconds to track backwards and play the previous track.

Support

NEED MORE HELP?

plantronics.com/support

Plantronics, Inc.

345 Encinal Street
Santa Cruz, CA 95060
United States

Plantronics B.V.

Scorpius 171
2132 LR Hoofddorp
Netherlands

© 2018 Bluetooth is a registered trademark of Bluetooth SIG, Inc. and any use by Plantronics, Inc. is under license. All other trademarks are the property of their respective owners.

Patents pending.

212548-06 (03.18)